



North Somerset Bat Survey

Quick Start Guide



Preparing the detector (batteries, SD card and switching on):

- The detector is protected with a snap-on lid. To remove the lid, grasp the long edges with your fingers, applying slight pressure with your thumbs to the centre. The lid will pop off to expose the recorder's interior.
- Remove the **four fully charged batteries** from the box and insert them into the slots in the bat detector, ensuring they are oriented with the correct positive/negative polarity. Please only use the batteries provided.
- Next, slide the SD card into the card slot until you hear a **click**.
- Now you are ready to turn on your detector, to do this all you have to do is push the small white power switch in the bottom left corner to **"On"**.
- When switched on, lights will turn on for the first minute. Look at the light which is above the words **"SD Card"** and below **"Defaults"**, it should be solid **green** and will start blinking. If the light is red, it means it is not inserted properly, you will need to push the SD card in further until you hear it **click into place**.

Using the Song Meter Configurator app to record survey location:

- Make sure the **Bluetooth and GPS tracking are turned on** your smart phone/tablet and open the Song Meter Configurator app.
- When you switch on the power for the bat detector, it will automatically be detected by the app, and it should appear on your phone screen in the app. Please note that the app requires that the host mobile device has a minimum Bluetooth chipset version of 4.0.

- Make sure the detector **lid is open** and the **app is open**, press the “**PAIR (hold)**” button on the detector down for **three seconds**.
- The light which is above the word “**Bluetooth**” and below the word “**Diags**” should start **flashing green**, indicating that the detector is ready to pair.
- A “**Pair**” icon will appear on your phone screen, tap this to pair your app with the detector. The detector’s details will turn green in the app, indicating you have successfully paired.

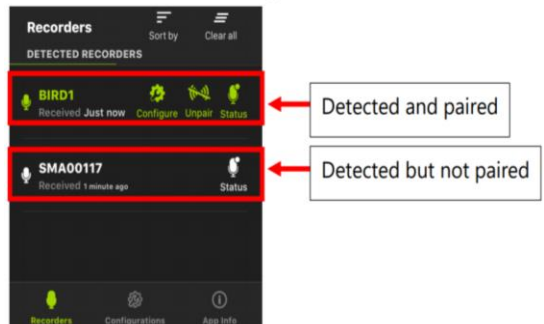

Photo credit: Wildlife Acoustics.

IMPORTANT- make sure you do this when the detector is in its recording location otherwise the GPS location will be inaccurate!

- A pop-up will ask you if you want to set the recorder’s location to your mobile device’s location. Tap “**Yes**”.
- Next, you will need to check the detector settings to ensure they are correct. Click the “**Configure**” icon and set the “**Schedule**” to “**Record bats 30 min before sunset to 30 min after sunrise (subject to triggering)**”.
- Then check the “**Ultrasonic settings**”, these should be set to:
 - Recording format= **Full-Spectrum**
 - Full spectrum sample rate= **384 kHz**
 - Minimum trigger frequency= **16 kHz**
 - Maximum recording length= **5 secs**
 - Trigger window= **3 secs**
 - Save noise files= **Off**

- Left channel gain= **12 dB**
 - Send Bluetooth beacons= **On**
- On the previous page, click “**Location & time zone**”, you should have already set the location, so only the time zone should be updated, please make sure it is set to “**UTC +01:00**”.
- Please “**Save**” the settings using the icon in the top right corner.
- Now return to the main page and tap the “**Unpair**” icon on the screen.
- Close the detector using the snap-on lid. Please make sure the lid clicks twice when closing to ensure it is watertight.
- Your detector is now **ready** to record! It will turn on automatically at the pre-set scheduled times until you collect it after six nights.

IMPORTANT- the detector should be kept in the same location for all nights, however, if for some reason this is not possible, please make sure you update the location using the app to pair again.

Attaching your detector:

- Your detector will need to be attached to a fence post, to do this, orientate the detector so that the logo is upright in the **bottom left corner**.



Photo credit: Wildlife Acoustics.

- Thread one reusable cable tie through the top holes on the detector and fasten it tightly against the post (use image for guidance). Use the other cable tie to do the same for the bottom holes. **Please note-** some shorter cable ties may need to be attached to each other to fit around the post.